

## CLEAT FOR MECHANICALLY LOCKED STANDING SEAM ROOF

### 1. Picture of the product

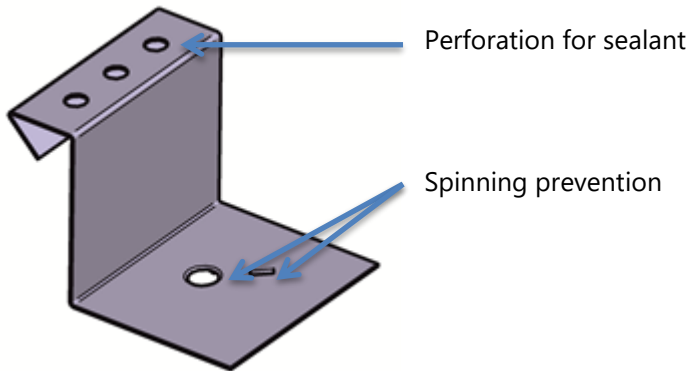

Figure 1. Perforated cleat  
the cleat

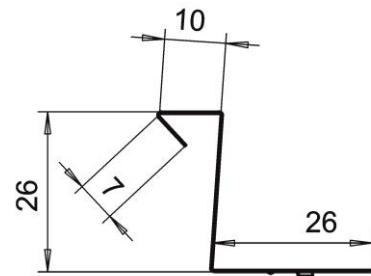

Figure 2. Dimensional drawing of

### 2. Product description

The fact that sealant is missing at the cleat locations and the spinning of cleats while drilling them onto the underlying boarding are considered as the biggest problems of the cleats in the market. We have taken these issues into account in the design of our cleat. We added perforation at the ridge of the cleat to allow the sealant to spread at the cleat locations as well. We also added a "barb" to the bottom to prevent the cleat from spinning while it is being attached. A predrilled hole is provided at the bottom of the cleat for screw attachment. The cleat is also available with a smooth base for nail attachment. All the cleats (steel) are made of soft 0.5 mm steel, allowing the cleat to adapt to the seam shape ideally.

### 3. Technical information

- Made of galvanised and painted steel (Nova) or acidproof steel.
- Material thickness: 0.5 mm for galvanised and painted steel, 0.3 mm for acidproof steel.